

F6

Fingerprint Standalone Access Control and RS485 FP Reader



F6 is an innovative biometric fingerprint reader for access control applications. Offering unparalleled performance using an advanced algorithm for reliability, precision and excellent matching speed. The device offers the flexibility to be installed

standalone or with any third party panels that support 26-bit wiegand. Also, it can work as FP reader using RS485 communication to transfer the template to ZK inBIO controller or standalone device.

Specifications

Fingerprint Capacity
500
Transaction Capacity
30,000

Communication
RS485, SD card
Wiegand Interface
Output

Optional Function
ID, Mifare card
Power Supply
12V DC

Access Control Interface for
3rd party electric lock, door sensor, exit button, alarm, Doorbell

Configuration

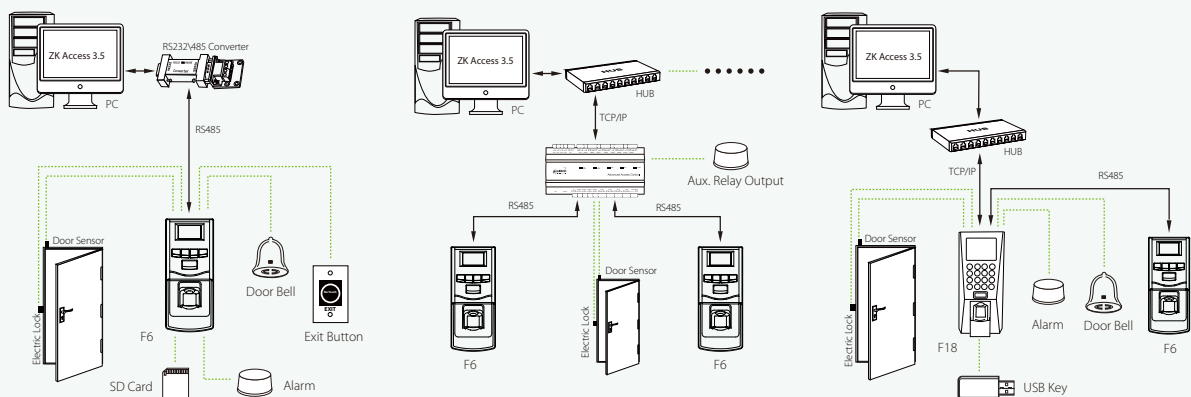

ZKTeco Inc.
ZK Mansion, Wuhe Rd, Gangtuo, Bantian, Buji Town,
Longgang District, Shenzhen China 518129
Tel: 86-755-8960 2345/46/47/48
E-mail: sales@zkteco.com
www.zkteco.com

Global Offices:
USA: +1 732-412-6007
EU: +34 916532891
Brazil: +55 31 2515-8326
Thailand: +66-027199154
Mexico: +52-55-52928418

South Africa: +27 12 259 1047
Egypt: +201110444134
Dubai: +971 4 6091 310
India: +91 8123536788
Indonesia: +62 21 2921 8949

Vietnam : +84-0169-5813007
Philippines: +63 9084118832
Russia: +8 915 178-46-81